

LP-C/RJ45/S

Measuring Principle

Lightning Protector Unit model LP-C/RJ45 is connected in series in CAT6 network cables, compatible with 10/100/1000/10000 (10G) Base-T Ethernet systems, protecting the equipment which are connected to the network (e.g. computers, routers, PoE devices, etc.) against damages by over-voltage surge.

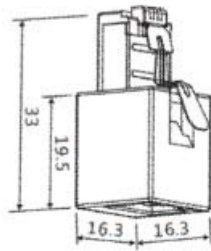

Feature

- Finger sized, easy to carry
- Plug and play, easy to use
- Low cost of repair and replacement
- 10/100/1000Mbps LAN adaptive, superior transmission performance
- Multi-level fine protection The circuit adopts the latest high-speed surge protection device, which has fast reflection speed and low output residual voltage

Application

- Network data system such as modems, servers, workstations and computer networks.

Main Technical Data

Model	LP-C/RJ45/S
Rated operating voltage U_e	1.4V
Max. continuous operating voltage U_c	3V
Wire to line nominal discharge current ($I_n @8/20\mu s$)	100A
Line to ground nominal discharge current ($I_n @8/20\mu s$)	500A
Voltage protection level ($U_p @line-line$)	<45V
Voltage protection level ($U_p @line-GND/PE$)	<300V
Transmission rate f_g	100MHz
Protection line	1,2,3,6 lines
Insertion loss	$\leq 0.5dB$
Line to line response time T_a	$\leq 1ns$
Line to ground response time T_a	$\leq 100ns$
Normal operating temperature	$-40^\circ C \sim 70^\circ C$

Wiring Diagram

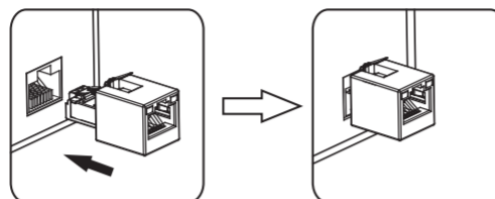
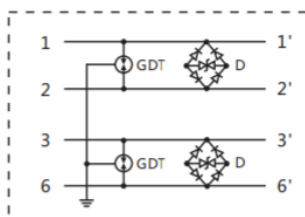

LKS West Instruments Sdn Bhd (834286-T)

No. 50-2, Jalan Sungai Rasau D32/D, Berjaya Park, Seksyen 32, 40460, Shah Alam, Selangor, Malaysia.

Tel: +603-5525 5038 Fax: +603-5525 5037 Email: info.west@lkssb.com.my Webpage: www.lkssb.com.my